

The information provided herein is from CONNELY Electronic Co., Ltd. and is confidential. Any disclosure to a party other than the recipient is prohibited. The intellectual properties and its rights contained herein, including but not limited to, trademarks, patents, copyrights, trade secrets, and technical know-how, are owned exclusively by CONNELY or its affiliates. Unauthorized use of this information in any format or manner, CONNELY may enforce its intellectual property rights at its own discretion; failures or delays to exercise such rights does not constitute a waiver of such rights.

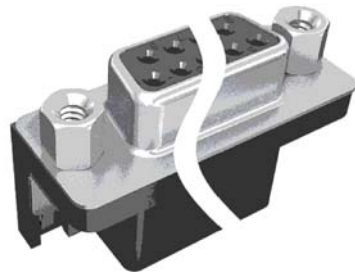
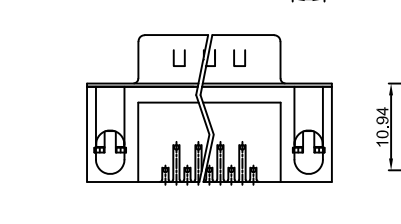
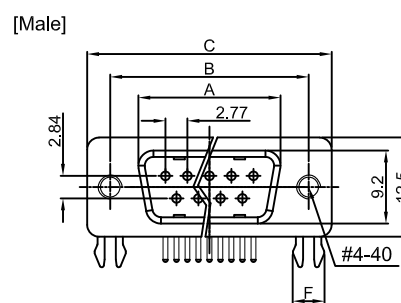
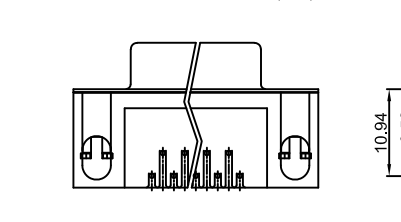
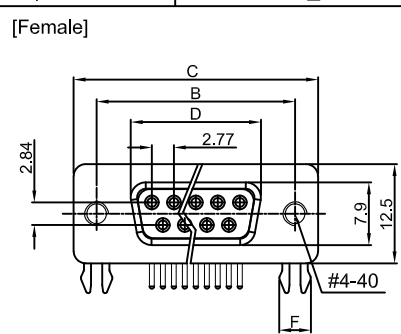

(Series Image-Reference Only)

Dimension

Position	A±0.2	B±0.2	C±0.3	D
9	17.90	24.99	30.80	16.33
15	26.50	33.32	39.14	24.66
25	40.00	47.04	53.04	38.38
37	56.50	63.50	69.32	54.84

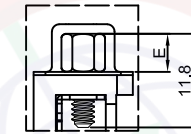

With screw type

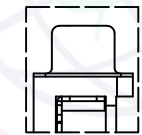

With rivet type

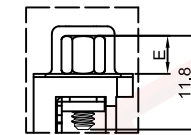

With screw and rivet type

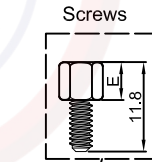

Screws

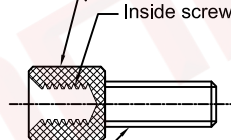

Inside screw thread

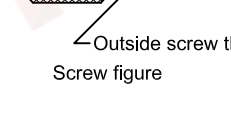

Outside screw thread

Screw figure

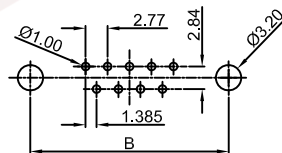

Recommend PCB layout  
(Tolerance:±0.05)

REV.	DESCRIPTION	DRAWN	CHECKED	APPROVED
A	NEW RELEASE	YCH 02/27/10'		LJC 02/27/10'
B	DRAWING UPDATE	JLZ 10/07/20'		
C	DRAWING UPDATE	JLZ 08/27/24'		

NOTES:

- Electrical characteristics:
    - Contact resistance: 20mΩ Max. Initial.
    - Dielectric withstanding voltage: 500V AC(rms) for 1 minute.
    - Insulation resistance: 1000MΩ Min.
  - Environment characteristics:
    - Temperature range: -40°C~+105°C.
  - Materials:
    - Insulator:PBT+Glass fiber
    - Shell:Steel
    - Contact:Copper alloy
  - Product number code:  
DS1037-04 - X X X X X X X X
- Screw DIM. E
  - 4: 4.80mm 5: 5.80mm
  - 6: 4.80mm(Inside thread M2.6\*0.45p, outside thread unc#4-40)
  - M3: 4.80mm(Inside thread M3.0, outside thread unc#4-40)
  - Board lock DIM. F
  - 7: 3.70mm
  - Contact plating
  - Si: Full gold flash
  - 6: Full tin
  - Color of housing
  - K: Black B: Blue
  - Screw type
  - A: With screw type B: With rivet type
  - C: With screw and rivet type
  - D: Rivet type with screws in bulk package
  - E: With rivet type(N/A Thread)
  - Shell plating
  - N: Nickel T: Tin
  - Connector type
  - M: Male F: Female
  - No. of contact
  - 09,15,25,37

GENERAL TOLERANCE		ANGLE TOLERANCE	
X.	±0.60	X.	±5°
.X	±0.38	.X	±3°
.XX	±0.25	.XX	±2°

DRAWING TYPE	CUSTOMER		
SCALE	1:1	SHEET	1 OF 1
DRAWING NO.	C-DS1037-04-XXXXXXX-C		

PROJECTION	TITLE	D-SUB	
		R/A(7.2mm) Machine Pin Type	
UNITS	mm	SERIES	DS1037-04 SERIES

